



## *Benbow Preserve*

*November 3, 2012*

The NeighborWoods tree planting program is designed to help restore the tree cover in Greensboro by planting trees in neighborhoods and open space. Up to 150 trees and shrubs are planted each year through volunteer support. *People of all ages and abilities are encouraged to participate in this event.*

---

**When:** Saturday, November 3. Please plan to arrive at 8:30 AM to meet your planting team and receive instructions. Planting begins at 9 AM - until finished (usually by noon).

**Where:** Benbow Preserve, a 6.5-acre property located intended for Open Space purposes, near the intersection of Britton Street and South Side Boulevard, across from Kindred Hospital. Specific details for parking are forthcoming.

---

**Volunteer Duties:** Soil preparation, tree planting, mulching, tree watering. Most of the heavy digging will be completed by Dunlap Lawn Service Inc. prior to the event. Each team will plant approximately 10 trees or shrubs and will be paired with a knowledgeable Tree Planting Supervisor. Although some equipment may be available on-site, all volunteers should bring work gloves, a shovel, a 5 gallon pail or bucket and dress appropriately for the weather –we plant rain or shine. Consider bringing smaller shovels and buckets for the younger members of your team.

---

**Registration:** Call to register and then email or bring a completed registration form with you for each volunteer, including children. If you are volunteering with a group, please call or e-mail to register your team so we can keep you together. On the day of the event, there will be a registration table for those with completed forms and for those who need forms.

### **Contact Us:**

For more information or to register on-line to volunteer, visit the NeighborWoods website and follow the link for “2012”: [www.greensboro-nc.gov/neighborwoods](http://www.greensboro-nc.gov/neighborwoods)

For questions or to register a team for NeighborWoods contact: Karen Markovics, Planning and Community Development at 336/412-5759 or [karen.markovics@greensboro-nc.gov](mailto:karen.markovics@greensboro-nc.gov)

---

### **Sponsorship:**

This year’s NeighborWoods Community Tree Planting Program is funded in part by a generous donation of \$10,000 from United Parcel Service (UPS). To help further the work of Greensboro Beautiful and the City’s Urban Forestry program, individuals are also encouraged to make private donations to Greensboro Beautiful’s Tree Fund. To make donations call Greensboro Beautiful, Inc. at 373-2199 or visit [www.GreensboroBeautiful.org](http://www.GreensboroBeautiful.org).





## REGISTRATION 2012

### **GREENSBORO BEAUTIFUL INC. AND CITY OF GREENSBORO PLANNING and COMMUNITY DEVELOPMENT DEPARTMENT**

#### **VOLUNTEER REGISTRATION/ AGREEMENT FORM**

I \_\_\_\_\_, in consideration for the opportunity to volunteer with Greensboro Beautiful Inc. and the City Of Greensboro Planning Department, do hereby acknowledge and agree to the following:

My work with the City of Greensboro Planning Department is strictly voluntary and I understand I will receive no compensation or employment benefits of any kind for this work. I also understand that I may be relieved of my duties as a volunteer at the sole discretion of the Planning Department.

My duties will be assigned to me by a member of the Planning Department Staff or Greensboro Beautiful. I will not engage in any duties for which I have not been assigned.

In addition to the above policies, I will not engage in any criminal activities while performing my volunteer services with the City of Greensboro.

I understand that I am not covered by the City of Greensboro Workers' Compensation insurance policy and acknowledge that I am not entitled to such coverage under the laws of the State of North Carolina because I am a volunteer.

I am at least eighteen years of age, or if not I have secured the signature of my parent or guardian (see below when applicable).

\_\_\_\_\_  
**Volunteer Signature**

\_\_\_\_\_  
**Date**

\_\_\_\_\_  
**Parent/Guardian if under 18 (Print & Sign)**

\_\_\_\_\_  
**Date**

**Name** \_\_\_\_\_

**Adult** \_\_\_ **Youth (under 18)** \_\_\_ **Team or Group** \_\_\_\_\_

**Address** \_\_\_\_\_

**City** \_\_\_\_\_ **State** \_\_\_\_\_ **Zip** \_\_\_\_\_

**Phone** \_\_\_\_\_

**Email** \_\_\_\_\_

(Greensboro Beautiful Inc may contact you via e-mail regarding their programs and other volunteer opportunities. If you do not wish to be included on their mailing list, please check here: \_\_\_\_\_ )



# Benbow Preserve NeighborWoods 2012

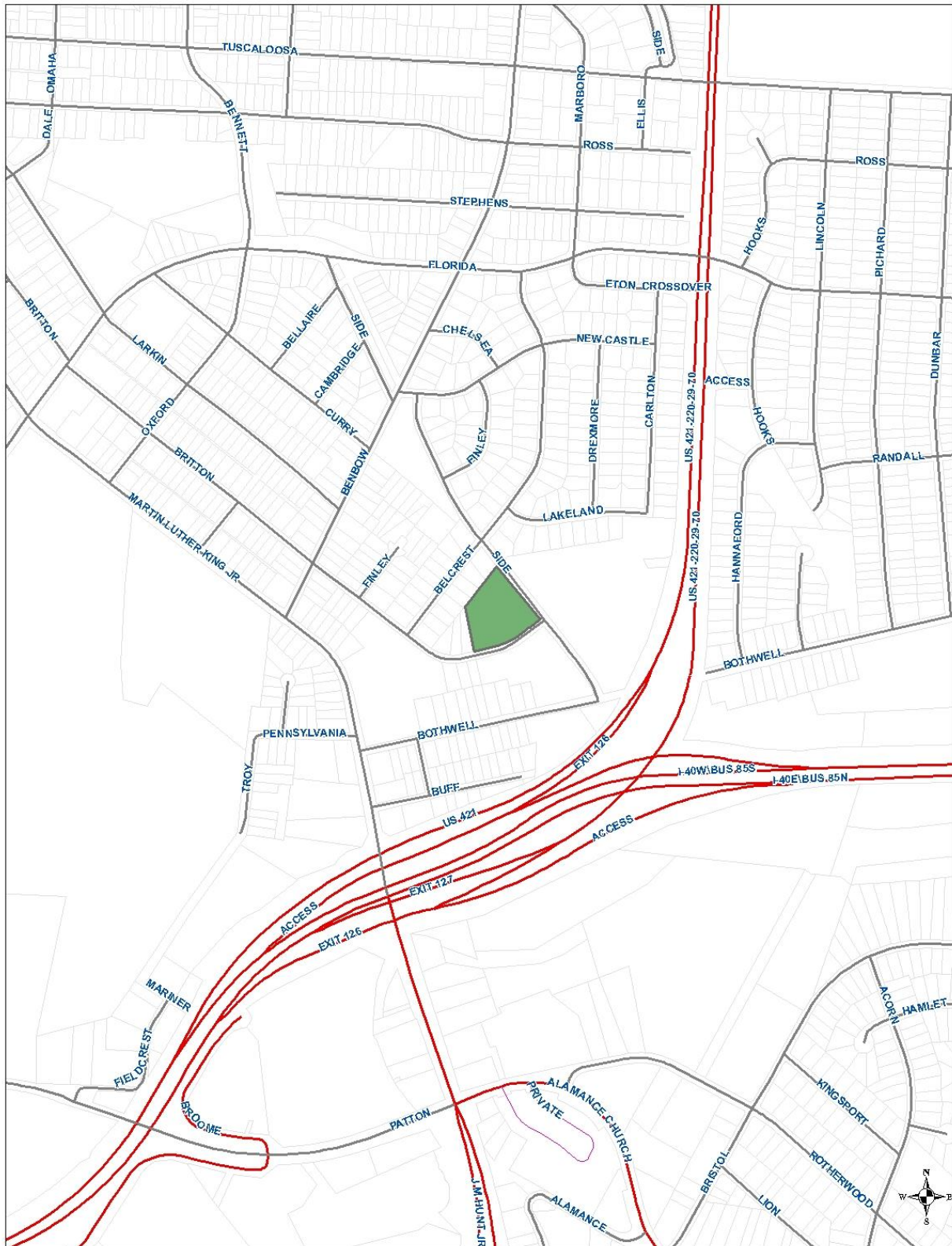

Prepared by the City of Greensboro,  
Planning and Community Development Department&tm/8-23-12

0 455 910 1,820 Feet